

Glass Fibre Flagpoles Installation

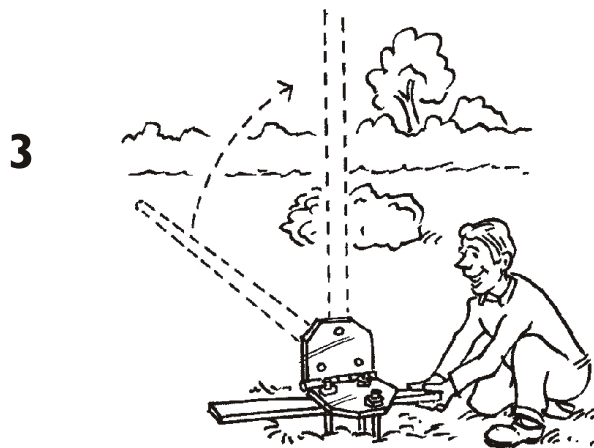

Level the tilt plate and support it with a board to prevent it sinking into the concrete. Remember to position the tilt plate to allow enough space for the flagpole.

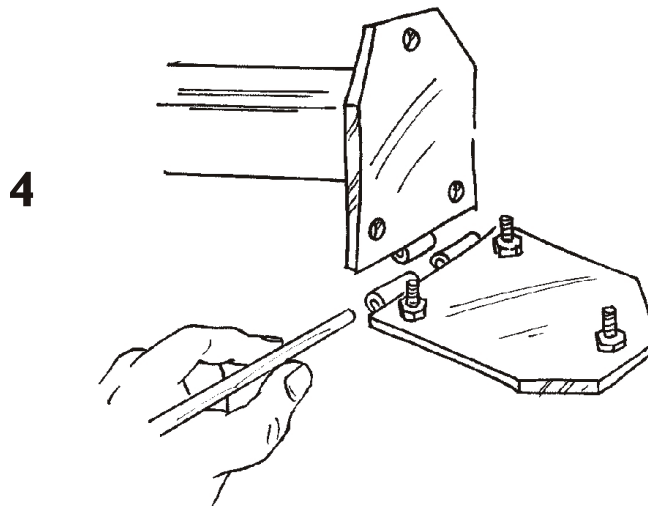

Once the concrete has set (3-7 days, depending on the season), connect the upper bracket on the flagpole to the tilt plate using the cranked cotter. Erect the flagpole and fasten it with nuts.